

Jabra

# Elite Active 65t



## User manual

© 2018 GN Audio A/S. All rights reserved. Jabra® is a trademark of GN Audio A/S. The Bluetooth® word mark and logos are registered trademarks owned by the Bluetooth SIG, Inc. and any use of such marks by GN Audio A/S is under license.

---

Made in China

MODEL: OTE070 / OTE071 /  
CPB070



---

**Declaration of Conformity** can be found on  
[www.jabra.com/doc](http://www.jabra.com/doc)

1. Welcome.....	5
2. Jabra Elite Active 65t overview.	6
2.1 Included accessories	
3. How to wear.....	8
3.1 Changing EarGels	
4. How to charge.....	10
4.1 Opening the charging case	
4.2 Charging the earbuds	
4.3 Charging the charging case	
4.4 What the LEDs mean	
5. How to pair.....	14
5.1 Pairing with a smartphone	
6. How to use .....	15
6.1 Turn the earbuds on/off	
6.2 Calls & music	
6.3 HearThrough	
6.4 Sidetone	
6.5 Auto-pause music	
6.6 Auto power off	
6.7 Mono earbud use	
6.8 Multiple call handling	
6.9 Multi-use	
6.10 Voice guidance and languages	

6.11	Voice assistant	
6.12	Update firmware	
6.13	How to reset	
7.	Jabra Sound+ app.....	23
8.	Support .....	24
8.1	FAQ	
8.2	How to care for your earbuds	
8.3	Replacement accessories	
8.4	Using a replacement earbud	
8.5	Using a replacement charging case	

# 1. Welcome

Thank you for using the Jabra Elite Active 65t.  
We hope you will enjoy it!

## **Jabra Elite Active 65t features**

- 4-microphone enhanced sound
- Customize your music
- Proven wireless connection
- Up to 15-hours battery
- Voice Assistant enabled
- 2-year warranty (dust & water). Registration required with the Jabra Sound+ app

## 2. Jabra Elite Active 65t overview

Jabra Elite Active 65t earbuds



On-the-go charging case

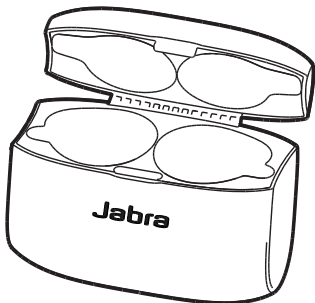

## 2.1 Included accessories

---

### EarGels

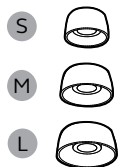

### Micro-USB cable



### 3. How to wear

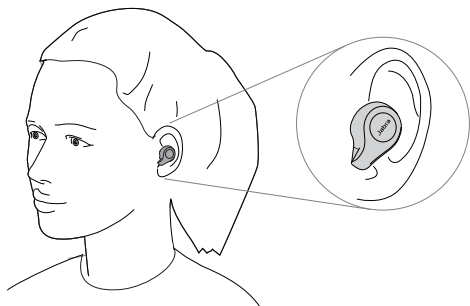

Insert the earbud into your ear and rotate to fit comfortably. Ensure the microphone is pointing towards your mouth.

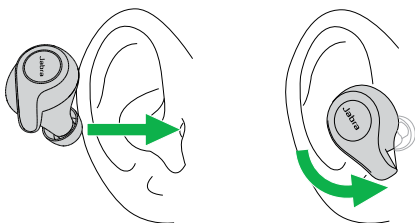



## 3.1 Changing EarGels

---

For the optimal audio experience, it is recommended to try each of the different EarGel sizes. The fit should feel tight and secure in your ear. The medium EarGel is pre-mounted on the earbuds. Ensure the EarGel is firmly attached.

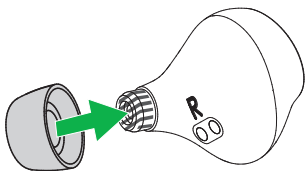

## 4. How to charge

With up to 5 hours of battery in the earbuds, and 2 recharges in the charging case, the Jabra Elite Active 65t offers up to 15 hours of playtime.

### 4.1 Opening the charging case

---

Firmly hold the charging case and press the small tab on the lid while opening the lid.

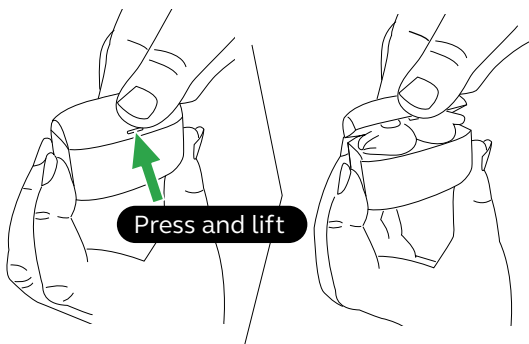

## 4.2 Charging the earbuds

---

Place the earbuds in the charging case and close the lid. The battery LED inside the charging case will flash red, yellow or green when the lid is opened to indicate the earbuds current battery status.

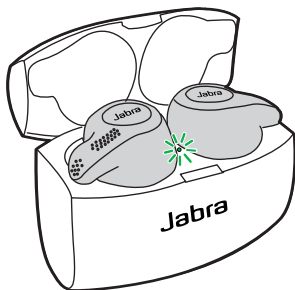

It takes approx. 2 hours to fully recharge the earbuds. If the earbuds are at low battery, you will get up to 1 hour of playtime by charging them in the charging case for 10 to 20 minutes.

## 4.3 Charging the charging case

---

Plug the charging case into a USB power supply or certified wall charger. It takes approx. 2 hours to fully charge the earbuds and the charging case.

Note: non-certified chargers may take longer to charge.

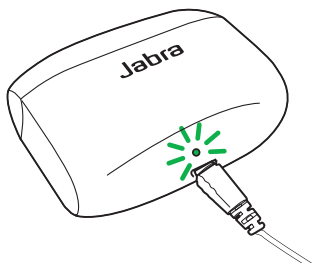

## 4.4 What the LEDs mean

---

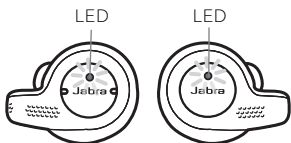

### EARBUD STATUS

- High battery/On
- Medium battery
- Low battery/Off
- Pairing
- Resetting

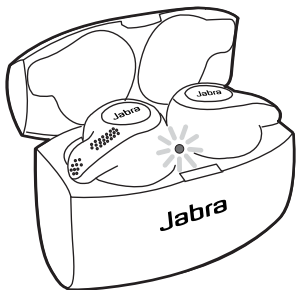

### EARBUD BATTERY STATUS

- High battery
- Medium battery
- Low battery



### CHARGING CASE STATUS

- High battery
- Medium battery
- Low battery
- Firmware updating

# 5. How to pair

## 5.1 Pairing with a smartphone

---

1. Ensure the right earbud is turned off and not in the charging case. To manually turn off the earbud, hold the **Multi-function** button until the LED flashes red.
2. Next, hold the **Multi-function** button on the right earbud for 5 seconds until you hear the connection instructions in the earbud and the LED flashes blue. Release the button, and follow the voice-guided instructions to pair to your smartphone.
3. You may need to hold the **Volume down** button for 1 second on the left earbud to turn it on.

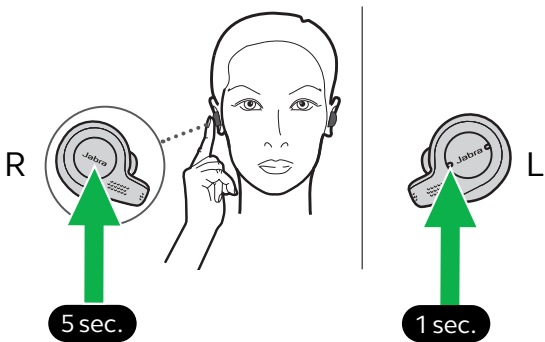

## 6. How to use

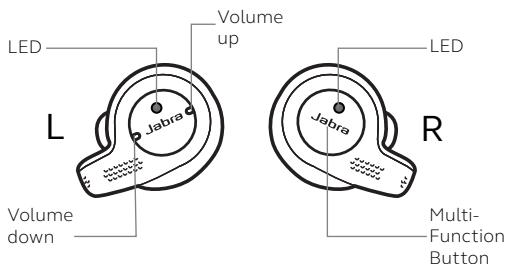

### 6.1 Turn the earbuds on/off

---

Place the earbuds in the charging case to turn them off, or remove them from the charging case to turn them on.

The earbuds can be turned on or off individually by holding the **Multi-function** button on the right earbud, or the **Volume down** button on the left earbud, until the LED flashes green (on) or red (off).

## 6.2 Calls & music

---

Right earbud	Calls & music	
	Play/pause music	Press the <b>Multi-function</b> button
	Answer/end call	Press the <b>Multi-function</b> button
	Reject call	Double-press the <b>Multi-function</b> button when there is an incoming call
	Voice assistant (Siri™, Google Now, etc)	Hold (1 sec) the <b>Multi-function</b> button when not on a call
	HearThrough on/off	Double-press the <b>Multi-function</b> button when not on a call

---



Left earbud	Calls & Music	
	Adjust volume	Press the <b>Volume up</b> or <b>Volume down</b> button
	Skip track	Hold (2 secs) the <b>Volume up</b> or <b>Volume down</b> button when listening to music
	Battery status	Press the <b>Volume up</b> or <b>Volume down</b> button when not on a call or listening to music

## 6.3 HearThrough

HearThrough utilizes the built-in microphones to enable you to pay attention to your surroundings and engage in conversation without needing to remove the earbuds.

HearThrough settings can be configured using the Jabra Sound+ app.

Right earbud	HearThrough	
	HearThrough on/off	Double-press the <b>Multi-function</b> button when not on a call

## 6.4 Sidetone

---

Sidetone enables you to hear your own voice when you are on a call.

Sidetone settings can be configured using the Jabra Sound+ app.

## 6.5 Auto-pause music

---

When you remove an earbud from your ear while listening to music, the music will automatically pause.

To unpause the music, place the earbud back into your ear within 60 seconds. After 60 seconds (or when mono playback is preferred) the music can be unpaused by pressing the **Multi-function** button.

Auto-pause music settings (available February 2018) can be configured using the Jabra Sound+ app.

## 6.6 Auto power off

---

To conserve battery the right earbud will automatically power off when it is out of range of your smartphone for 15 minutes and is not in the charging case, or when it has been inactive for 1 hour.

The left earbud will automatically power off when it has not had a link with the right earbud for 15 minutes and is not in the charging case.

To power the earbuds on, place them in the charging case, or hold the **Multi-function** button on the right earbud, and/or the **Volume down** button on the left earbud, until the LED flashes.

## 6.7 Mono earbud use

---

The right earbud can be used alone for mono playback or for calls. For volume and/or skip track controls, please use your connected smartphone.

When both earbuds are turned on and within 20 centimetres (8 inches) of one another, they will automatically relink.

## 6.8 Multiple call handling

---

The earbuds can accept and handle multiple calls at the same time.

Right earbud	Multiple call handling	
	End current call and answer incoming call	Press the <b>Multi-function</b> button
	Put current call on hold and answer incoming call	Hold (2 secs) the <b>Multi-function</b> button
	Switch between held call and active call	Hold (2 secs) the <b>Multi-function</b> button
	Reject incoming call, when on a call	Double-press the <b>Multi-function</b> button

## 6.9 Multi-use

---

The earbuds can be paired to two smartphones at once, and can accept multiple incoming calls from either smartphone.

To pair to two smartphones, use the normal pairing process separately for each smartphone (refer to section 5).

## 6.10 Voice guidance and languages

---

Voice guidance can be turned on/off (available February 2018) and the language can be changed using the Jabra Sound+ app.

The following languages are available: English, French, German, Japanese, Chinese.

## 6.11 Voice assistant

---

To activate your smartphone's Voice assistant (e.g. Siri, Google Now™, etc) hold the **Multi-function** button when not on a call.

Voice assistant settings (available February 2018) can be configured using the Jabra Sound+ app.

## 6.12 Update firmware

---

The Jabra Elite Active 65t can be updated to the latest firmware version using the Jabra Sound+ app.

If notifications are enabled in the Jabra Sound+ app you will receive an automatic notification when a firmware update is available.

## 6.13 How to reset

---

Resetting the earbuds clears the list of paired devices and resets all settings.

Right  
earbud

Reset earbuds



Reset pairing list  
and settings

Hold (10 secs) the **Multi-function** button until the LED flashes purple.

The earbuds will need to be re-paired to your smartphone.

---

## 7. Jabra Sound+ app



Jabra Sound+ app



Customize  
your music



Manage  
HearThrough



Register your  
2-year warranty



# 8. Support

## 8.1 FAQ

---

View the FAQs on [Jabra.com/eliteactive65t](https://www.jabra.com/eliteactive65t).

## 8.2 How to care for your earbuds

---

- Always store the earbuds in the charging case and safely protected.
- To prevent the depletion of the battery lifetime or capacity, avoid storing the earbuds in hot or cold environments, such as a closed car in summer, or in winter conditions.
- It is recommended to keep the earbuds between 15°C and 25°C (59°F and 77°F).
- Do not store the earbuds for extended periods of time without recharging them (max. three months).
- If the earbuds or the charging case become dirty, it is recommended to clean them with a soft, lint-free cloth that has been dampened with clean water.



## 8.3 Replacement accessories

---

Replacement or additional accessories can be purchased online at [jabra.com/accessories](http://jabra.com/accessories).

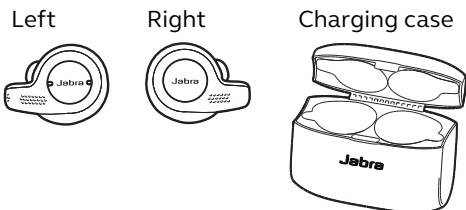

### EarGels

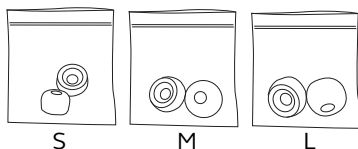

## 8.4 Using a replacement earbud

---

Before using a replacement earbud it will need to be synced with your current earbud and the charging case.

To sync, place the replacement earbud into the charging case along with your current earbud, and close the lid. The LED on the charging case

may flash purple to indicate that the firmware is being updated. Please wait until the LED stops flashing purple before opening the charging case.

Note: if the replacement earbud was the right earbud, you will need to re-pair it to your smartphone, and then update the firmware using the Jabra Sound+ app.

## 8.5 Using a replacement charging case

Before using a replacement charging case for the first time, it will need to be synced with your current earbuds and charged for 1 hour.

To begin syncing, place your current earbuds inside the replacement charging case, and close the lid. The LED on the charging case may flash purple to indicate that the firmware is being updated. Please wait until the LED stops flashing purple before opening the charging case.

[jabra.com/eliteactive65t](https://jabra.com/eliteactive65t)